

NOTES:

1. THIS DETAIL APPLIES TO ONE AND TWO STOREY BUILDINGS CONFORMING TO PART 9 OF THE 2010 NATIONAL BUILDING CODE OF CANADA OR PART 9 OF THE LOCAL PROVINCIAL BUILDING CODE.
2. REINFORCE THE FOUNDATION WALL AS PER THE FOX BLOCKS CANADIAN ENGINEERING SPECIFICATIONS WHERE THE FOUNDATION SUPPORTS AN EXTERIOR SURCHARGE LOAD OR WHERE THE BACKFILL EXCEEDS THE LIMITS OF TABLE 1.

TABLE 1. MAXIMUM HEIGHT OF FINISH GROUND ABOVE BASEMENT FLOOR

MINIMUM WALL THICKNESS	HEIGHT OF FOUNDATION WALL		
	≤ 2.5m (8'-2")	>2.5m AND ≤2.75m (9'-0")	>2.75m AND ≤3.0m (9'-10")
6"	1.8m (5'-10")	1.6m (5'-3")	1.6m (5'-3")
8"	2.3m (7'-6")	2.3m (7'-6")	2.2m (7'-2")
10"	2.3m (7'-6")	2.6m (8'-6")	2.85m (9'-4")
12"	2.3m (7'-6")	2.6m (8'-6")	2.85m (9'-4")



This drawing is only to be used as a reference. The user shall check to ensure the drawing meets local building codes and construction practices by consulting local building professionals and officials. Changes to the drawing may be made by Fox Blocks without notice and assumes no liability in connection with the use of this drawing including modifications, copying or distribution.

Title:

FOUNDATION WALL - STRAIGHT TOP

Date:

AUG. 2015

Drawing:

FW-1

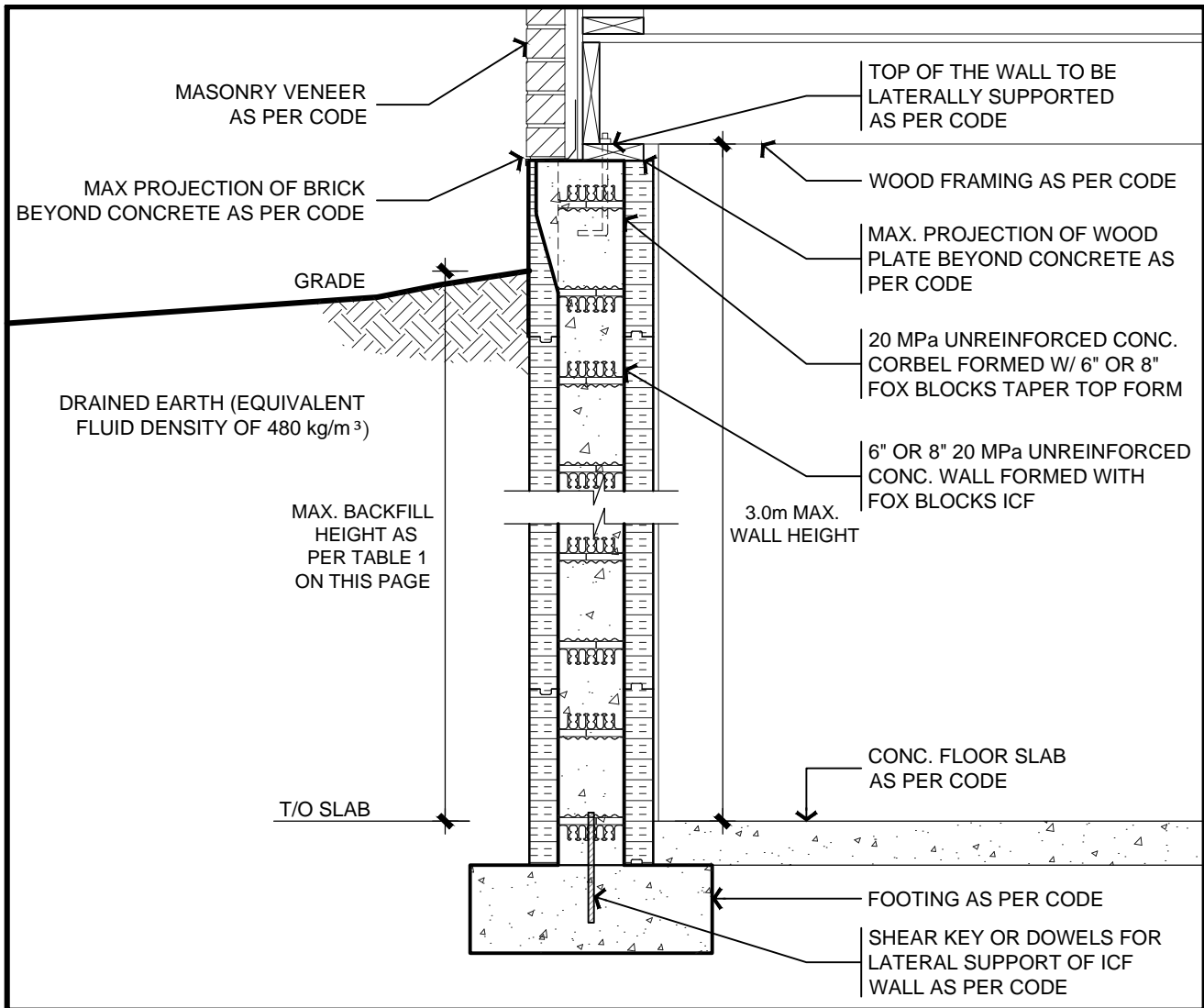

NOTES:

1. THIS DETAIL APPLIES TO ONE AND TWO STOREY BUILDINGS CONFORMING TO PART 9 OF THE 2010 NATIONAL BUILDING CODE OF CANADA OR PART 9 OF THE LOCAL PROVINCIAL BUILDING CODE.
2. REINFORCE THE FOUNDATION WALL AS PER THE FOX BLOCKS CANADIAN ENGINEERING SPECIFICATIONS WHERE THE FOUNDATION SUPPORTS AN EXTERIOR SURCHARGE LOAD OR WHERE THE BACKFILL EXCEEDS THE LIMITS OF TABLE 1.

TABLE 1. MAXIMUM HEIGHT OF FINISH GROUND ABOVE BASEMENT FLOOR

MINIMUM WALL THICKNESS	HEIGHT OF FOUNDATION WALL		
	≤ 2.5m (8'-2")	>2.5m AND ≤2.75m (9'-0")	>2.75m AND ≤3.0m (9'-10")
6"	1.8m (5'-7")	1.6m (5'-3")	1.6m (5'-3")
8"	2.3m (7'-6")	2.3m (7'-6")	2.2m (7'-2")



This drawing is only to be used as a reference. The user shall check to ensure the drawing meets local building codes and construction practices by consulting local building professionals and officials. Changes to the drawing may be made by Fox Blocks without notice and assumes no liability in connection with the use of this drawing including modifications, copying or distribution.

Title:

FOUNDATION WALL - TAPER TOP

Date:

AUG. 2015

Drawing:

FW-2

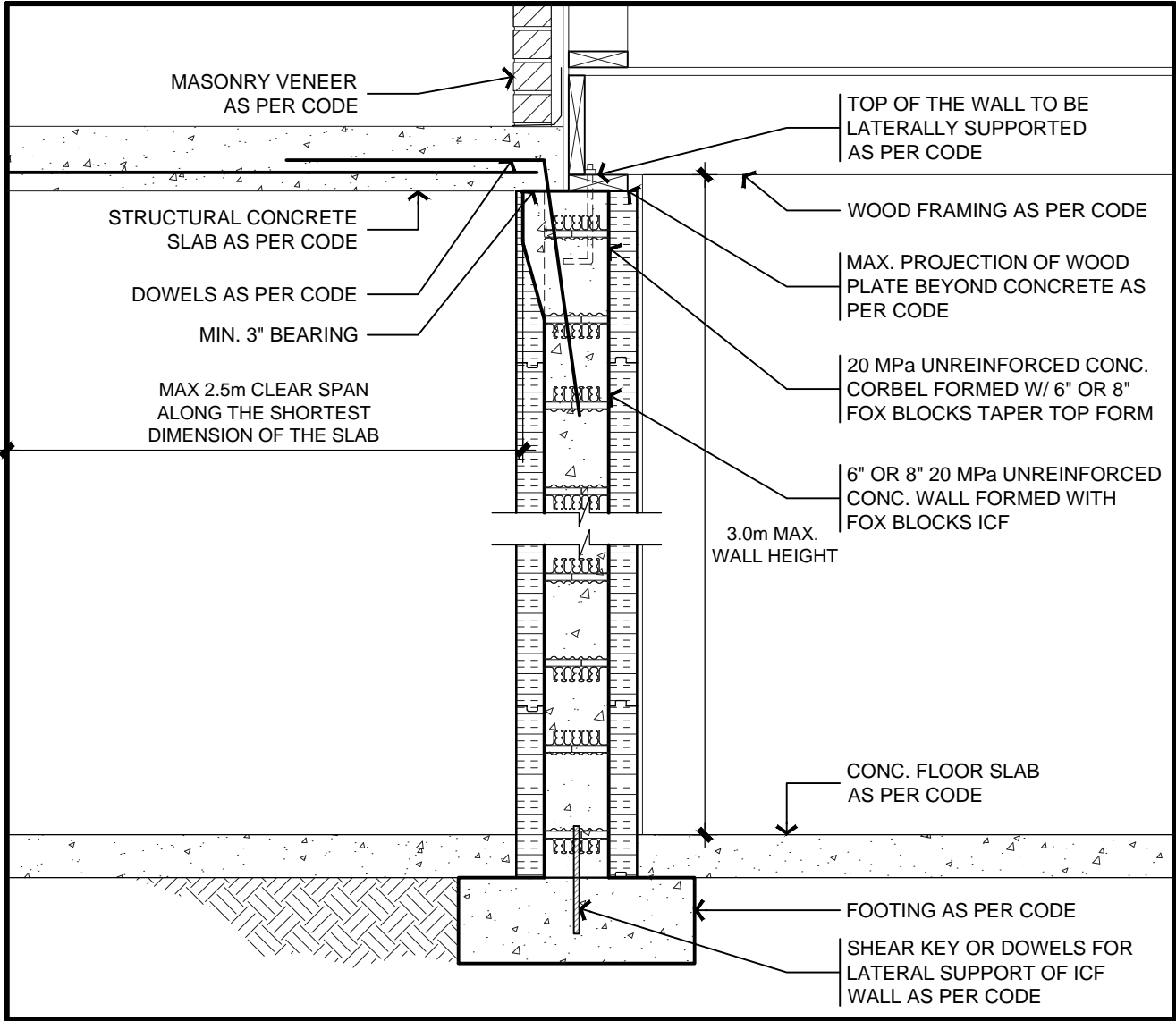

NOTES:

1. THIS DETAIL APPLIES TO TWO STOREY BUILDINGS CONFORMING TO PART 9 OF THE 2010 NATIONAL BUILDING CODE OF CANADA OR PART 9 OF THE LOCAL PROVINCIAL BUILDING CODE.



This drawing is only to be used as a reference. The user shall check to ensure the drawing meets local building codes and construction practices by consulting local building professionals and officials. Changes to the drawing may be made by Fox Blocks without notice and assumes no liability in connection with the use of this drawing including modifications, copying or distribution.

Title:
FOUNDATION WALL - STRUCT. SLAB

Date:
 AUG. 2015

Drawing:
 FW-3